

# Guide Rail Accessories

## Adjusting Rods



Part No.	Shaft Length	OD	Thread
351703-516	3"	1/2"	5/16"
351703-38	3"	1/2"	3/8"
351704-516	4"	1/2"	5/16"
351704-38	4"	1/2"	3/8"
351705-516	5"	1/2"	5/16"
351705-38	5"	1/2"	3/8"
351706-516	6"	1/2"	5/16"
351706-38	6"	1/2"	3/8"
351707-516	7"	1/2"	5/16"
351707-38	7"	1/2"	3/8"
351708-516	8"	1/2"	5/16"
351708-38	8"	1/2"	3/8"
351709-516	9"	1/2"	5/16"
351709-38	9"	1/2"	3/8"
351710-516	10"	1/2"	5/16"
351710-38	10"	1/2"	3/8"
351712-516	12"	1/2"	5/16"
351712-38	12"	1/2"	3/8"
351714-516	14"	1/2"	5/16"
351714-38	14"	1/2"	3/8"
351715-516	15"	1/2"	5/16"
351715-38	15"	1/2"	3/8"
351718-516	18"	1/2"	5/16"
351718-38	18"	1/2"	3/8"

Part No.	Shaft Length	OD	Thread
361703-516	3"	5/8"	5/16"
361703-38	3"	5/8"	3/8"
361704-516	4"	5/8"	5/16"
361704-38	4"	5/8"	3/8"
361705-516	5"	5/8"	5/16"
361705-38	5"	5/8"	3/8"
361706-516	6"	5/8"	5/16"
361706-38	6"	5/8"	3/8"
361707-516	7"	5/8"	5/16"
361707-38	7"	5/8"	3/8"
361708-516	8"	5/8"	5/16"
361708-38	8"	5/8"	3/8"
361709-516	9"	5/8"	5/16"
361709-38	9"	5/8"	3/8"
361710-516	10"	5/8"	5/16"
361710-38	10"	5/8"	3/8"
361712-516	12"	5/8"	5/16"
361712-38	12"	5/8"	3/8"
361714-516	14"	5/8"	5/16"
361714-38	14"	5/8"	3/8"
361715-516	15"	5/8"	5/16"
361715-38	15"	5/8"	3/8"
361718-516	18"	5/8"	5/16"
361718-38	18"	5/8"	3/8"

## SlideRails

Heavy-duty SlideRails provide a low-friction surface ideal for roller combiner and accumulation applications. High performing acetal balls are low maintenance and have a long life. SlideRail channels are made from 10-gauge stainless and galvanized steel. The 304 stainless steel pins in each SlideRail provide superior service in harsh environments, and the pin rails are glass-filled nylon. Two-inch key slots are designed for 3/8" carriage bolts and are 12" on center.



### 2" SlideRails

Stainless Steel	Galvanized Steel	Length	Height
SSR-2-02	GSR-2-02	2'	2"
SSR-2-03	GSR-2-03	3'	2"
SSR-2-04	GSR-2-04	4'	2"
SSR-2-06	GSR-2-06	6'	2"
SSR-2-07	GSR-2-07	7'	2"
SSR-2-08	GSR-2-08	8'	2"
SSR-2-09	GSR-2-09	9'	2"
SSR-2-10	GSR-2-10	10'	2"

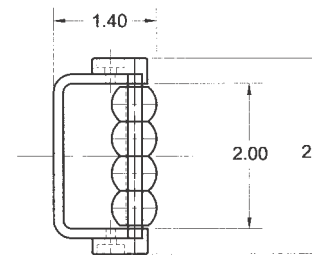

### 3" SlideRails

Stainless Steel	Galvanized Steel	Length	Height
SSR-3-02	GSR-3-02	2'	3"
SSR-3-03	GSR-3-03	3'	3"
SSR-3-04	GSR-3-04	4'	3"
SSR-3-06	GSR-3-06	6'	3"
SSR-3-07	GSR-3-07	7'	3"
SSR-3-08	GSR-3-08	8'	3"
SSR-3-09	GSR-3-09	9'	3"
SSR-3-10	GSR-3-10	10'	3"

